

SIDE CONTROL PUMPER 1500 GPM #2483



TECHNICAL SPECIFICATIONS

- Spartan Metro Star ELFD 10" Raised Roof Chassis
- Cummins L9 450 HP Diesel Engine
- Allison 3000 EVS Automatic Transmission
- Heavy Duty 304L Stainless-Steel Body and 304L Stainless-Steel Sub-Frame with Lifetime Warranty
- Five (5) Person Cab
- ROM Series IV Satin Finish Roll-Up Doors
- EMS Compartment with ROM Roll-Up Door, Rear Wall of Cab with Full Height, External Access Doors Both Sides
- Side Control Stainless-Steel Pump Module with 50,000 BTU Water Heater, Heat Enclosure, and Hose Well, Left Side
- Hale QMAX-XS 150 1500 GPM Pump
- Hale ESP Priming Pump
- Hale SAM Control Panel
- 30-Gallon Compressed Air Foam System with Hale SmartCAFS Controller
- Two (2) 6" Intakes with Hale MIV Valves, One (1) Each side
- One (1) 2½" Gated Intake, Left Side
- One (1) 5" Front Intake adapted to 6" NST with Low Level Strainer
- Two (2) 2½" Foam Capable Discharges with Akron Electric Valves, Left Side
- One (1) 2½" Discharge with Akron Electric Valve, Right Side
- One (1) 3" Discharge with Akron Electric Valve adapted to 4" Storz, Right Side
- One (1) 2½" Discharge with Akron Electric Valve, Rear
- Foam Capable Cartridge Lay Preconnects with Akron Electric Valve, Two (2) 1½", One (1) 2½"
- One (1) 2½" Foam Capable Front Bumper Preconnect with Akron Electric Valve
- One (1) 2½" Rear Tank Fill
- Akron Deckmaster Electric Monitor with Akromatic 1250 Nozzle
- 1250-Gallon Poly Tank
- Three (3) Triple Air Bottle Wheel Well Compartments, One (1) Left Side ahead of wheel well, Two (2) Right Side
- One (1) Hinged PAC TRAC Tool Board, R3 Compartment
- PAC TRAC Tool Board Upper Rear Wall, L1 and R3 Compartments
- Cribbing Containment Door, L2 Compartment
- 500# Roll-Out Tray, One (1) Each, R1 and Rear Compartments
- Spacesaver 400V Vertical Fill Enclosure with Air Control Panel with Slide-Out Platform, L3 Compartment
- Four (4) Cascade 6000 psi Bottles, Rear
- Zico Hydraulic Ladder Rack with One (1) 14' Roof Ladder and One (1) 35' Two (2) Section Ground Ladder, Right Side
- One (1) 17' Little Giant Storage Compartment Above the Pump Module
- Progressive Dynamics 40 Amp Battery Charger with Kussmaul Auto Eject 120V Shoreline Connection
- Vanner VLT12 3000W Inverter, L1 Compartment
- Whelen Warning Light Package
- FireTech Side and Rear Scene Lights
- Two (2) Akron Telescopic Lights, One (1) Each Side behind the cab
- One (1) Backup Camera with Cab Display
- Nine (9) Folding Steps, Three (3) Each, Pump Module Left Side, Rear Left Side, Rear Right Side
- Diamond Grade Chevron Striping
- Whelen Electric Siren with 100 Watt Speaker
- 10' 3" Overall height
- 36' 3" Overall length
- 238" Wheelbase
- 164" Cab to Axle
- 21,500 FAWR
- 31,000 RAWR
- 51,500 GVWR



CUSTOMER APPROVAL SIGNATURE: _____ DATE: _____

WALNUT-0006

IN THE EVENT THERE ARE DISCREPANCIES BETWEEN THE DRAWING AND THE SPECIFICATIONS, THE SPECIFICATIONS SHALL PREVAIL.

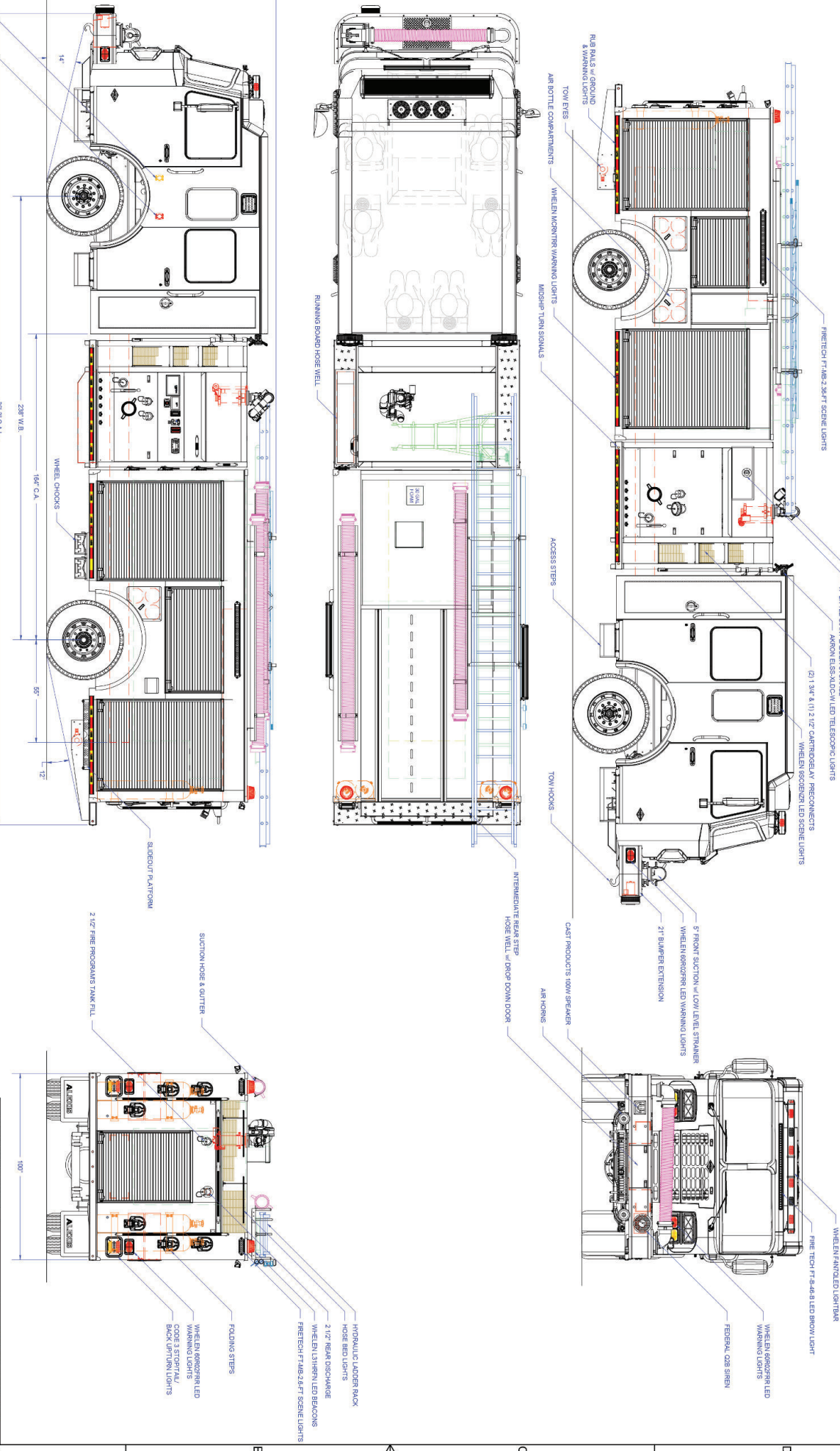

COMPARTMENT DIMENSIONS

COMP #	DOOR OPENING SIZES
L1 & R1	57" WIDE X 62" HIGH X 28" DEEP
L2	54" WIDE X 25" HIGH X 28" DEEP
R2	46" WIDE X 62" HIGH X 28" DEEP
L3 & R3	36" WIDE X 45" HIGH X 28" DEEP

UNLESS OTHERWISE SPECIFIED
 DIMENSIONS ARE IN INCHES
 DIMENSIONS ARE NOT DIMINUTIVE

ALEXIS FIRE EQUIPMENT CO.
 P.O. BOX 459, MENA, MISSOURI 64452

PUMPER
 WALNUT FIRE DEPARTMENT
 WALNUT, IL

DATE: 10/29/20
 DRAWN BY: J. HENNING
 SIZE: 1/2" = 1"
 CONTRACT #: 2483
 SHEET 1 OF 2

REVISION HISTORY

REV	DESCRIPTION	DATE	BY
01	QUANTRY ORDER	4/18/22	JWH
02	SALES UPDATE	8/18/21	JWH
03	SALES UPDATE	8/18/21	JWH
04	SALES UPDATE	7/15/21	JWH
05	ADDED CHANGE BOTTLES	2/19/21	MKT
06	SALES UPDATE	1/19/21	MKT

Control Location

APPARATUS TYPE	PUMPER
CHASSIS	Spartan 74-BCC
TANK CAPACITY	1250
TANK MAKE	Hale
PUMP MAKE	Omni-XS
PUMP MODEL	Omni-XS
PUMP GPM	1500

Material

Material	Stainless Steel
----------	-----------------

Material

Material	Stainless Steel
----------	-----------------

Material

Material	Stainless Steel
----------	-----------------

Material

Material	Stainless Steel
----------	-----------------

Material

Material	Stainless Steel
----------	-----------------

Material

Material	Stainless Steel
----------	-----------------

Material

Material	Stainless Steel
----------	-----------------

Material

Material	Stainless Steel
----------	-----------------

Material

Material	Stainless Steel
----------	-----------------