

# CUSTOM TOP MOUNT PUMPER

MARKEY TOWNSHIP FIRE DEPARTMENT / HOUGHTON LAKE, MICHIGAN



# ALEXIS



THANK YOU TO MARKEY TOWNSHIP FIRE DEPARTMENT FOR THE PURCHASE OF THIS UNIT.

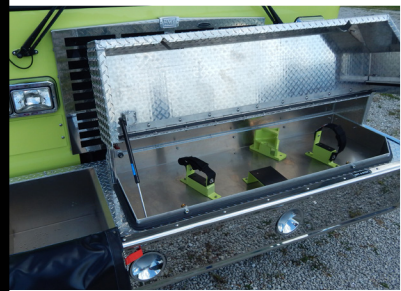

## TECHNICAL SPECIFICATIONS

- HME 1871W MFDxL 12" raised roof Chassis
- Cummins ISL9, 450-HP Diesel Engine
- Allison 3000 EVS Automatic Transmission
- Six (6) man cab seating with five (5) SCBA seats
- Heavy Duty 14 gauge 304, #4 finish stainless steel Body
- Stainless Steel Sub-frame
- ROM Roll Up Doors with right side R2 hemmed drop down door
- 1000-Gallon Poly Tank
- Darley PSM 1500-GPM Pump
- Pump operator's panel across top of the apparatus
- Four (4) 2 1/2" Discharges, two (2) left, one (1) right side and one (1) rear
- Two (2) 3" Discharges, one (1) right side and one (1) over pump for deck gun
- One (1) Akron Apollo deck gun with Akromatic master stream nozzles
- One (1) 2 1/2" Gated Suction, left side
- One (1) 5" rear suction with 6" adapter
- Two (2) 1 1/2" Cartridge Lay preconnects, front of pump module
- Darley 150 CFM CAFS system
- FoamPro 2002 Foam system with 20-Gallon foam tank
- 18" Front bumper extension with rescue tool storage and 1 1/2" preconnect
- Three (3) Dual bottle Air bottle compartments, two (2) right and one (1) left side
- Ziamatic Electrically controlled ladder rack, right side
- Suction hose storage compartment for two (2) hoses with rear access, right side
- EQ2B Electronic Siren with 200-watt speaker, cab grill
- Two (2) Air Horns, front bumper
- Kussmaul 1200 Pump Plus on-board battery charger/air compressor
- Kussmaul Super Auto Eject 120-volt shoreline connection
- Fire Research Spectra L80 Scene Light Package
- Code 3 LED Warning Light Package
- Diamond Grade Chevron pattern striping, rear
- 9' 10" Overall height • 18,740 FAWR
- 33' 8" Overall length • 27,000 RAWR
- 213" Wheelbase • 45,740 GVWR
- 153" Cab to Axle



To view more photos and download spec sheet, please visit us at [AlexisFire.com](http://AlexisFire.com).

CUSTOMER APPROVAL SIGNATURE: \_\_\_\_\_ DATE: \_\_\_\_\_

**ALEXIS-0001**

IN THE EVENT THERE ARE DISCREPANCIES BETWEEN THE DRAWING AND THE SPECIFICATIONS, THE SPECIFICATIONS SHALL PREVAIL.

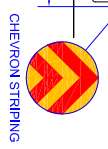
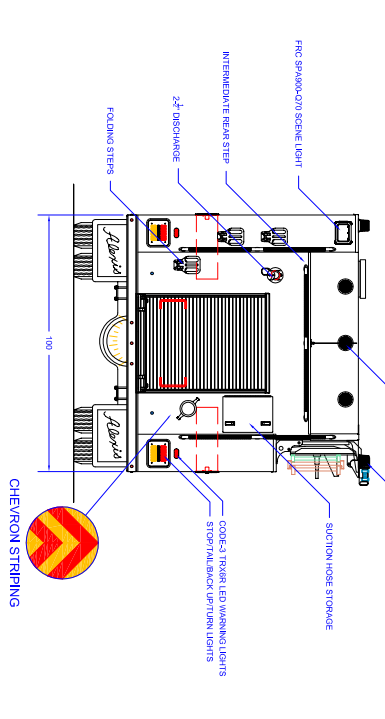
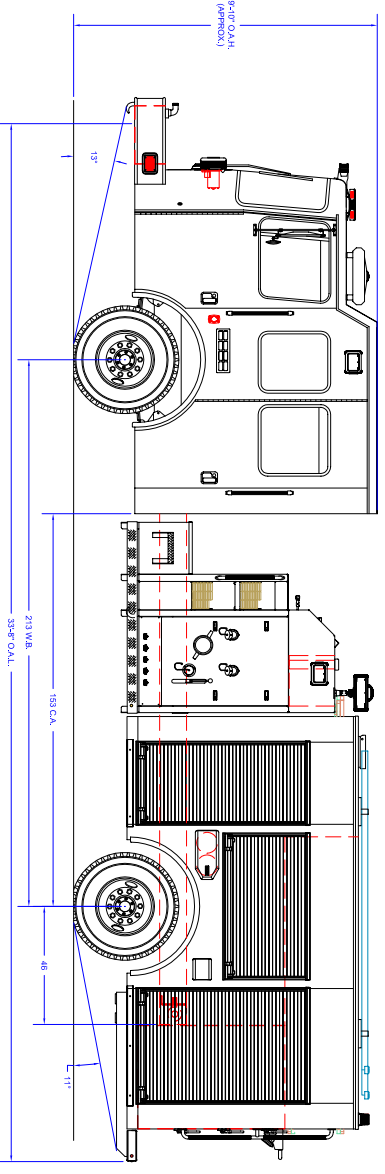
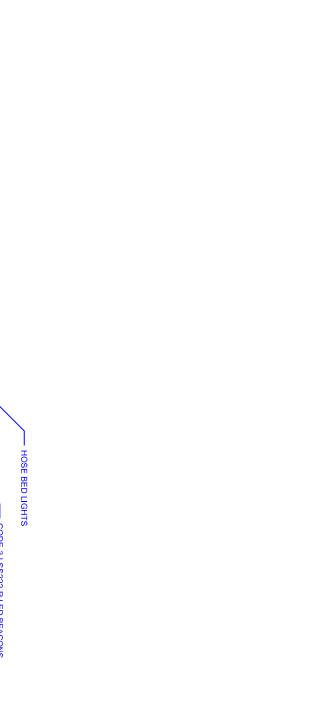
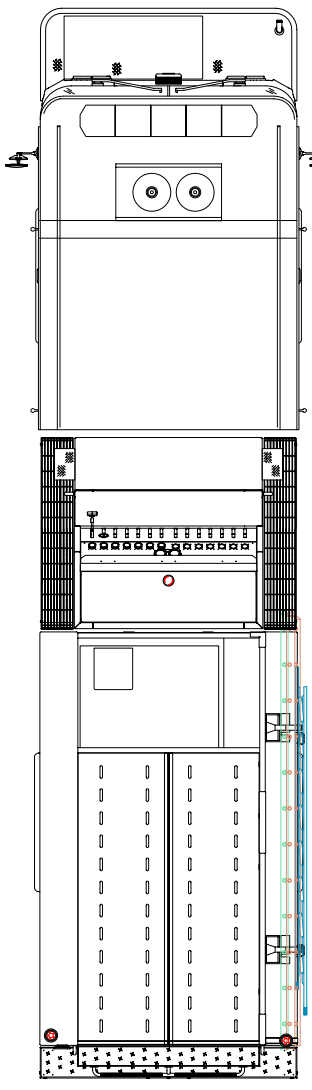
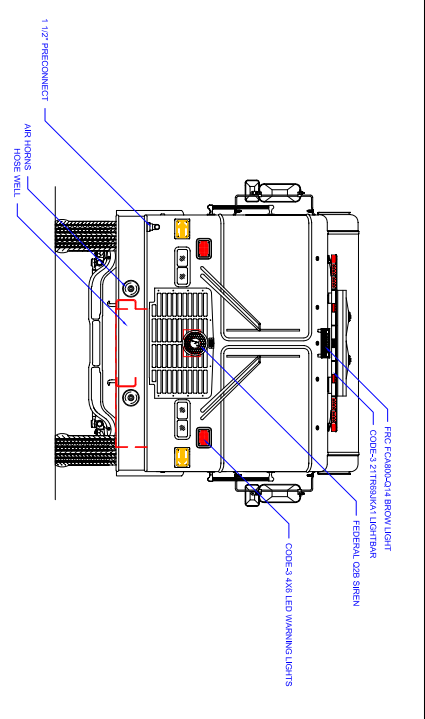
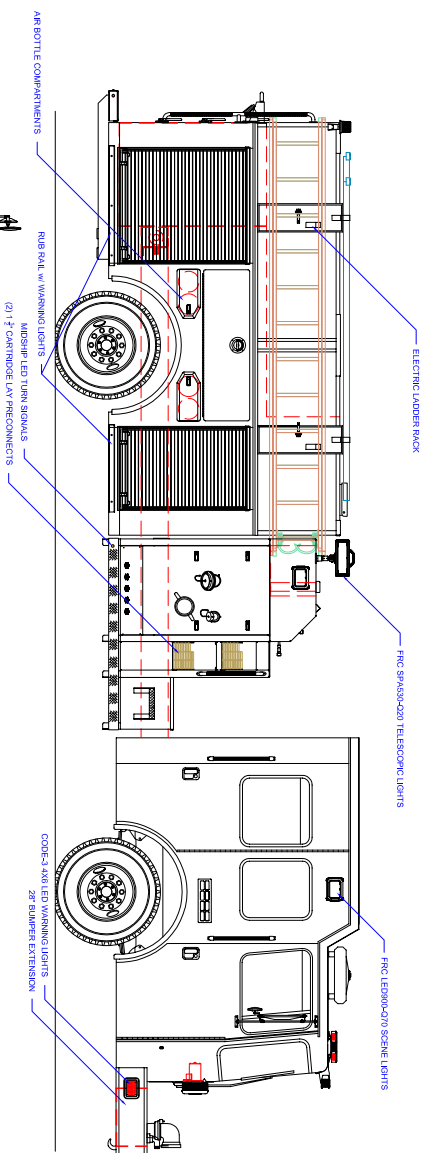

**COMPARTMENT DIMENSIONS**

COMP #	DOOR OPENING SIZES	UNLESS OTHERWISE SPECIFIED, DIMENSIONS ARE IN INCHES. DIMENSIONS ARE NOT CONCLUSIVE.
L1	30" WIDE X 61" HIGH X 12" DEEP	PREDOMINANT 4" DIA. METRIC 4 x 8mm
L2	54" WIDE X 27" HIGH X 12" DEEP	
L3	42" WIDE X 61" HIGH X 12" DEEP	
R1	30" WIDE X 61" HIGH X 12" DEEP	
R2	56" WIDE X 45" HIGH X 12" DEEP	
R3	42" WIDE X 45" HIGH X 12" DEEP	
REAR	35" WIDE X 44" HIGH X 37" DEEP	

REQ #	DESCRIPTION	DATE	QTY	UNIT	6	5	4
01	REAR/FRONT/DRY	5/21/16	1	HAZ			
02	CHANGE ORDER 3"	5/21/16	1	HAZ			
01	SALES UPDATES	5/21/16	1	HAZ			

COMP #	DESCRIPTION	DATE	QTY	UNIT	6	5	4
01	Control cabinet 100"	5/21/16	1	HAZ			
02	Pump Drive - SILENT SHIRT	5/21/16	1	HAZ			
03	Pump Motor - SILENT SHIRT	5/21/16	1	HAZ			
04	Change Order 3"	5/21/16	1	HAZ			
05	Pump Model - PSM	5/21/16	1	HAZ			
06	Pump GPM - 1500	5/21/16	1	HAZ			

**Flowline** FIRE EQUIPMENT CO.  
 P.O. BOX 568 ALEXIS LUNDS 61412

**MARKEY TWP FIRE DEPT**  
 HOUGHTON LAKE, MI  
 P-V78A

SIZE SCALE: D 1/2"=1'  
 DWG NO: 2314  
 SHEET: 1 OF 2