

TOP MOUNT EQUALIZER PUMPER



ABINGDON FIRE PROTECTION DISTRICT :: ST. AUGUSTINE UNIT
ABINGDON, ILLINOIS

TECHNICAL SPECS

- Freightliner M2 106 2-Door Chassis
- Cummins ISC-330, 330-HP Diesel Engine
- Allison 3000 EVS Automatic Transmission
- Heavy Duty 3/16" Aluminum Body
- ROM Roll Up Doors
- 1000-Gallon Poly Tank
- Waterous CXS-PA, 1250-GPM Pump
- Pump operator's panel across top of body
- Two (2) 2 1/2" Discharges, one (1) each side
- Three (3) 3" Discharges, one (1) right side, one (1) rear and one (1) over pump
- Two (2) 1 1/2" Preconnects, behind cab
- One (1) 2 1/2" Gated Suction, left side
- Two (2) Dual bottle Air bottle compartments, one (1) each side wheel well
- Ladder storage compartment through the tank with rear access
- Four (4) FlameFighter walk-away air pack brackets, right side
- One (1) Hinged tool board, left side
- Progressive Dynamics on-board battery charger with Viair air compressor
- Kussmaul Super Auto Eject 120-volt shoreline
- Whelen Electronic Siren with 100-watt Cast Products speaker
- Whelen LED Scene Light Package
- Whelen LED Warning Light Package
- Chevron pattern striping, rear
- 9' 9" Overall height
- 28' 10" Overall length
- 210.5" Wheelbase
- 145" Cab to Axle
- 14,600 FAWR
- 27,000 RAWR
- 41,600 GVWR



To view more photos,
visit www.AlexisFire.com

**WE WOULD LIKE TO THANK
THE ABINGDON FIRE PROTECTION
DISTRICT FOR THEIR BUSINESS.**

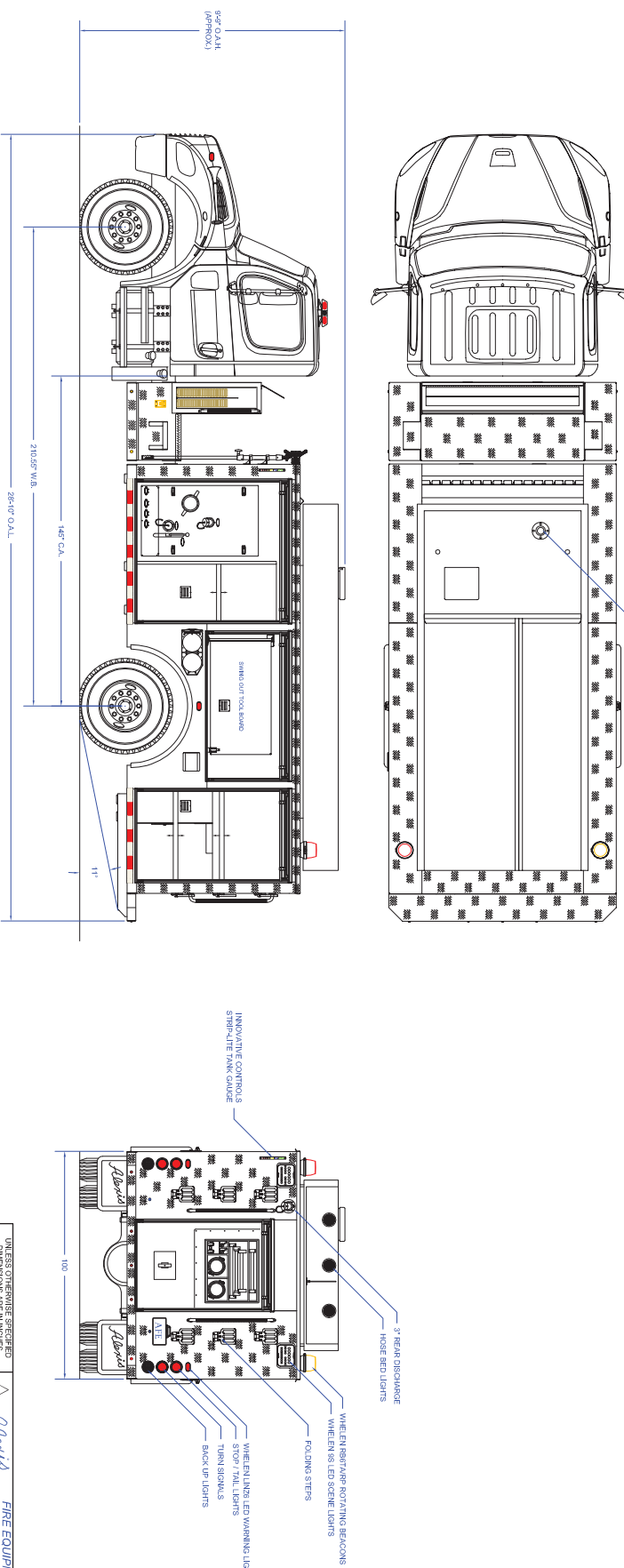

[illegible]