

# TOP CONTROL PUMPER

HENRY FIRE PROTECTION DISTRICT / HENRY, ILLINOIS



# ALEXIS



THANK YOU TO THE HENRY FIRE PROTECTION DISTRICT FOR THE PURCHASE OF THIS UNIT.



## TECHNICAL SPECIFICATIONS

Spartan Metro Star EMFD 10" Raised Roof Chassis  
Cummins L9 450 HP Diesel Engine  
Allison 3000 EVS Automatic Transmission  
Heavy Duty Stainless-Steel Body and Sub-Frame  
Five (5) Person Cab  
One (1) Center Console with Switches  
6" Front Bumper Extension  
Satin Finish ROM Roll-Up Doors  
1000-Gallon Poly Tank  
20-Gallon Foam Tank for Waterous Aquis  
1.5 Foam System  
Stainless-Steel Top Control Pump Module  
Hale QMAX 200 Single Stage Split-Shaft  
2000 GPM Pump  
Trident Air Prime System with Additional Primer  
FRC Pump Boss Pressure Governor & Monitoring System  
Hose Bed with Three (3) 5" LED Lights  
Two (2) 6" Intakes with Akron Hand Wheel  
Butterfly Valves, One (1) Left, One (1) Right  
One (1) 2½" Gated Intake, Left Side  
One (1) 5" Rear Intake  
Two (2) 1½" Cartridge Lay Foam  
Capable Preconnects  
One (1) 2½" Discharge, Left Side  
One (1) 2½" Discharge, Right Side  
One (1) 4" Discharge, Left Side Adapted to 5" Storz  
One (1) 4" Discharge, Right Side, Adapted to 5" Storz  
Akron 3423 Deck Gun with 18" Task Force  
Tips Extend-A-Gun  
One (1) 10" Newton Stainless-Steel Dump with  
Electric Valve, Rear

One (1) Zico Hydraulic Ladder Rack, Right Side  
One (1) Fire Extinguisher Storage Compartment,  
Left Side Ahead of Wheel Well  
Two (2) Triple Air Bottle Compartments, Right Side  
PacTrac Upper Rear Wall of L1, L3, R1,  
R3 Compartments  
Hinged PacTrac Tool Board, L2 Compartment  
Five (5) 500# Roll-Out Trays, L1, L3, R1, R3,  
Rear Compartments  
One (1) Kussmaul 120V 20A Shoreline Connection,  
Cab Left Side  
Whelen Warning Light Package  
Whelen and FireTech Scene Lights  
Akron Telescopic Scene Lights, One (1) Each Side  
Federal Q2B Siren  
inView 360° Backup Camera System, One (1)  
Camera Each Side and Rear, Displays in Cab and at  
Pump Panel  
One (1) 120V Power Strip in Each Compartment  
Aluminum Rub Rails with LED Warning Lights & LED  
Ground Lighting  
Diamond Grade Chevron Striping  
10' 6" Overall height  
34' 7" Overall length  
233" Wheelbase  
173" Cab to Axle  
20,000 FAWR  
27,000 RAWR  
47,000 GVWR



To view more photos and download spec sheet, please visit us at [AlexisFire.com](http://AlexisFire.com).

CUSTOMER APPROVAL SIGNATURE: \_\_\_\_\_ DATE: \_\_\_\_\_

**HENRY-0004**

IN THE EVENT THERE ARE DISCREPANCIES BETWEEN THE DRAWING AND THE SPECIFICATIONS THE SPECIFICATIONS SHALL PREVAIL.

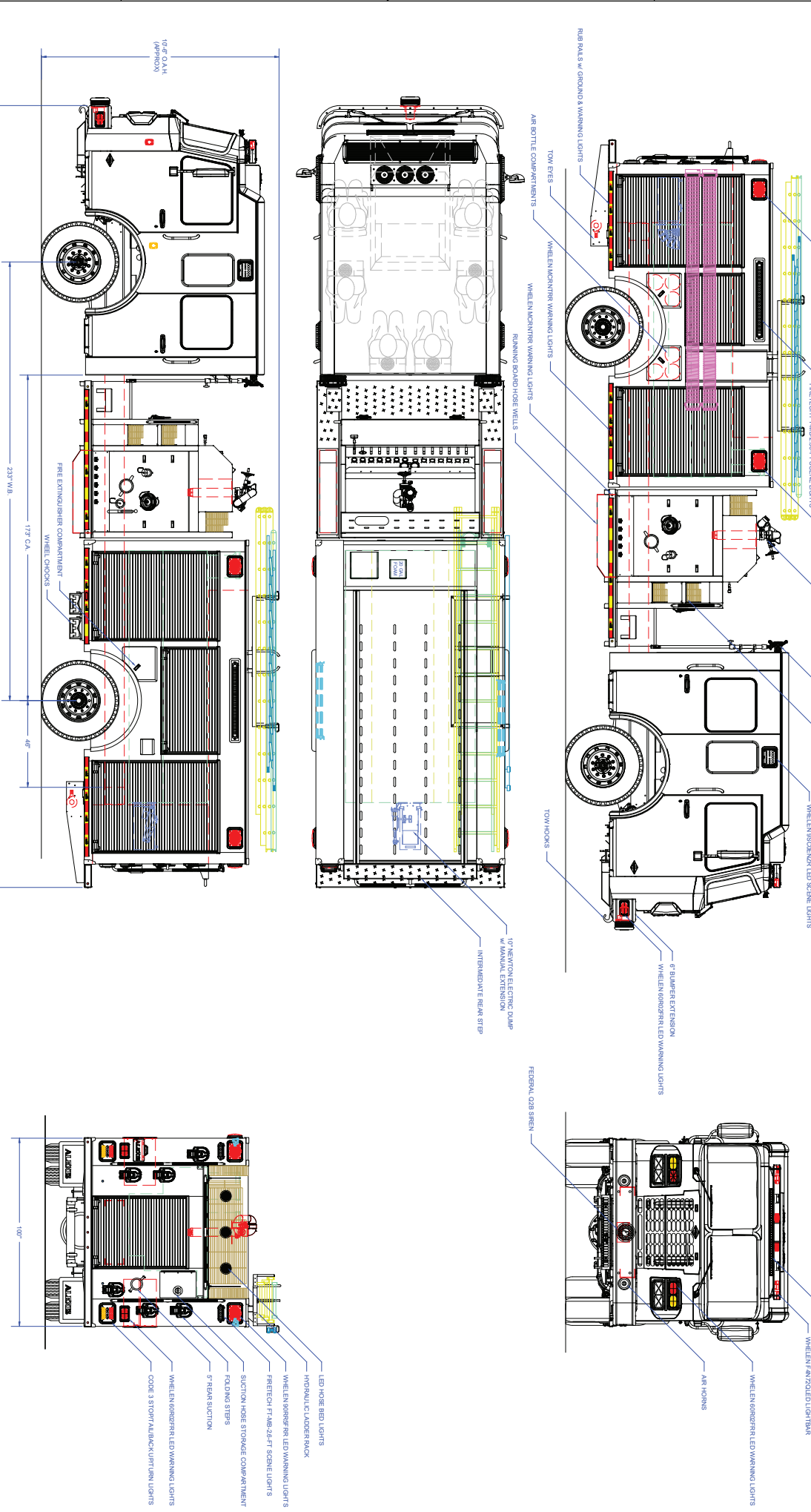

**COMPARTMENT DIMENSIONS**

COMP. #	DOOR OPENING SIZES	
L1 & R1	45" WIDE X 62" HIGH X 12'28" DEEP	
R2	54" WIDE X 25" HIGH X 12' DEEP	
F2	38" WIDE X 25" HIGH X 12' DEEP	
L3 & R3	46" WIDE X 62" HIGH X 12'28" DEEP	
REAR	36" WIDE X 45" HIGH X 2'9" DEEP	

REV	DESCRIPTION	DATE	DWN	Pump Location
01	SALES UPDATE	9/29/21	JMH	Pump GYM - 2000
02	SALES UPDATE	9/18/21	JMH	Pump Model: Omaha
03	SALES UPDATE	9/23/21	JMH	Pump Maker: Hale
04	DESCRIPTION	2/11/21	DWH	Control Location: Top

APPARATUS TYPE	TYPE	PUMPER
CHASSIS	SPARTAN	60 - BCC
TANK CAPACITY	1000	
MATERIAL	STAINLESS STEEL	

UNLESS OTHERWISE SPECIFIED	
DECIMAL: 4/10002	
ANGULAR: 1/32"	
FRACTIONAL: 1/16" MINIMUM 1/8" MINIMUM	
The copyright of this drawing and design and the right of reproduction therein is reserved and belongs to Henry Equipment Co.	

UNLESS OTHERWISE SPECIFIED	
DECIMAL: 4/10002	
ANGULAR: 1/32"	
FRACTIONAL: 1/16" MINIMUM 1/8" MINIMUM	
The copyright of this drawing and design and the right of reproduction therein is reserved and belongs to Henry Equipment Co.	

ALEXIS FIRE EQUIPMENT CO.	
P.O. BOX 648, ALEXIS, ILLINOIS 61412	

TOP CONTROL PUMPER	
HENRY, IL	

SIZE SCALE	1/8"=1'
D	1/2"=1'
CONTROL #	2489
SHEET	1 OF 2
PART NO	P-Z25