

TOP MOUNT PUMPER



ALEXIS FIRE PROTECTION DISTRICT
ALEXIS, ILLINOIS

TECHNICAL SPECS

- Freightliner M2 106 4-Door Chassis
- Cummins ISL, 350-HP Diesel Engine
- Allison 3000 EVS Automatic Transmission
- Five (5) Man cab seating with four (4) SCBA seats
- Heavy Duty Stainless Steel Body with ROM painted Roll Up Doors
- 1000-Gallon Poly Tank
- One (1) 2 1/2" Tank Fill, rear
- One (1) Newton 10" square electric dump with 36" manual extension
- Waterous CXS, 1250-GPM Pump with pump operator's controls across top
- Six (6) 2 1/2" Discharges, two (2) each side and two (2) rear
- One (1) 2 1/2" Gated Suction, left side
- One (1) 3" Discharge, over pump for deck gun
- One (1) Akron Apollo Deck Gun with stream shaper, stacked tips and mounts
- Two (2) 1 1/2" Mattydale Preconnects, front of pump module
- Two (2) Pump module compartments, one (1) each side under walkway
- One (1) free floating hose well, right side running board
- Four (4) Dual bottle Air bottle compartments, two (2) each side wheel well
- One (1) Swing out tool board, left side
- Zico Hydraulic Ladder Rack with Suction hose and pike pole storage, right side
- One (1) Suction hose storage gutter, left side
- Progressive Dynamics on-board battery charger with Viair Air compressor
- Floor mounted console for emergency switches with map/binder storage
- Whelen Electronic Siren with 100-watt Whelen speaker
- Five (5) Akron Revel LED Scene lights, two (2) each side and one (1) rear
- One (1) Akron Revel LED Brow light
- Weldon LED Warning Light Package
- Diamond Grade Chevron pattern striping, rear
- 10' 1" Overall height
- 33' 10" Overall length
- 266" Wheelbase
- 153.2" Cab to Axle
- 14,600 FAWR
- 30,000 RAWR
- 44,600 GVWR



To view more photos,
visit www.AlexisFire.com

**WE WOULD LIKE TO THANK
THE ALEXIS FIRE PROTECTION DISTRICT
FOR THEIR BUSINESS.**



Demand To Be Different.

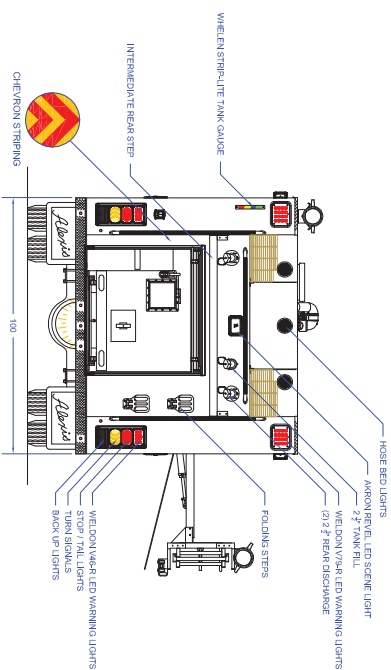
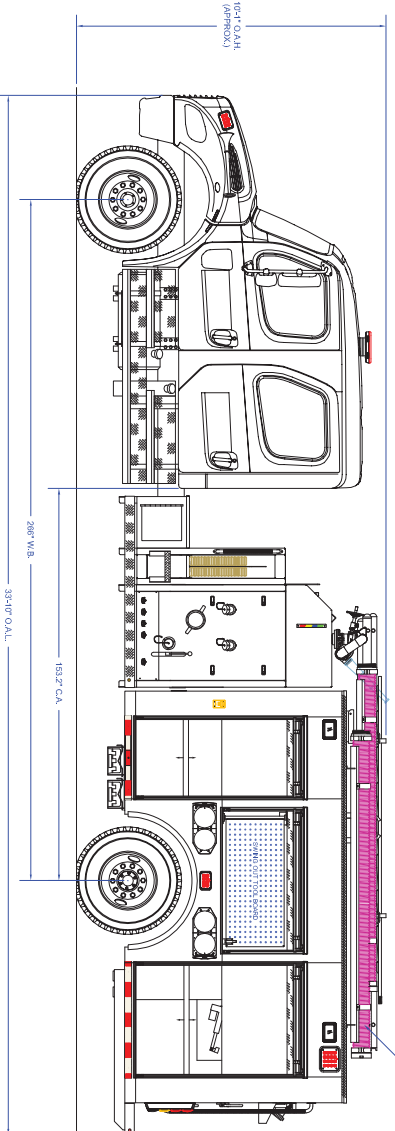
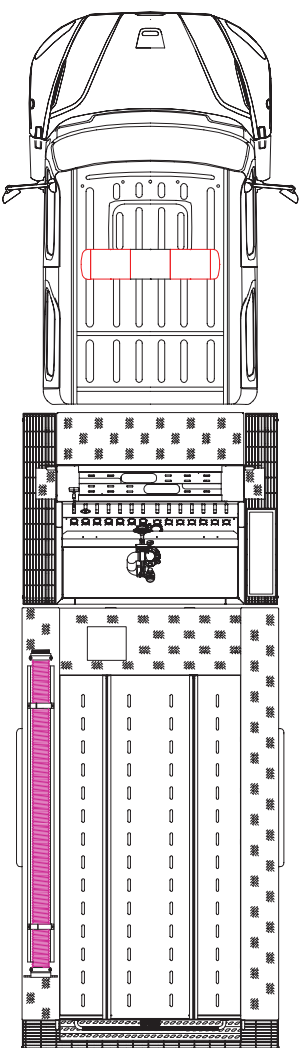
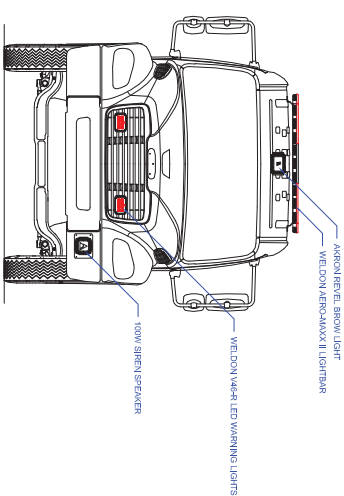

UNLESS OTHERWISE SPECIFIED DIMENSIONS ARE IN INCHES TOLERANCES ARE NOT CUMULATIVE	 FIRE EQUIPMENT CO. P.O. BOX 549, ALEXIS, ILLINOIS 61414
---	--

COMPARTMENT DIMENSIONS	
COMP #	DOOR OPENING SIZES

COMP #	DOOR OPENING SIZES
L1 & R1	30" WIDE X 61" HIGH X 1725" DEEP
L2	54" WIDE X 27" HIGH X 172" DEEP
R2	35" WIDE X 27" HIGH X 172" DEEP
L3 & R3	42" WIDE X 61" HIGH X 1725" DEEP
R4/R	48" WIDE X 40" HIGH X 37" DEEP

UNLESS OTHERWISE SPECIFIED		FIRE EQUIPMENT CO.	
TOLERANCES ARE NOT CUMULATIVE		P.O. BOX 569 ALEXIS, ILLINOIS 61417	
DEPTH, ± 0.002	ANGLE, ± 0.5	 ALEXIS FIRE PROTECTION DISTRICT ALEXIS, ILLINOIS	
PROTUMPT, ± 0.10	METRIC, ± 0.10		
The weight of the drawing and design, and the project information there is verified in and being to Alexis Fire Equipment Co.			
DRUM	1/2 H	SIZE	2000
M/TUMCHAM	1/2 H	SIZE	2000
MATERIAL	CONTRACT	2000	2000
SHEET 1 OF 2		P-V33	