

CUSTOM 1000-GALLON TOP-MOUNT PUMPER

AKRON-PRINCEVILLE FIRE PROTECTION DISTRICT / PRINCEVILLE, IL



ALEXIS



THANK YOU TO THE AKRON-PRINCEVILLE FIRE PROTECTION DISTRICT FOR THE PURCHASE OF THIS UNIT.



TECHNICAL SPECIFICATIONS

- Spartan Metro Star LFD 10" Raised Roof Chassis
- Six (6) Person Cab Seating w/ Five (5) SCBA Seats
- Cummins L9 450-HP Diesel Engine
- Allison 3000 EVS Automatic Transmission
- Heavy Duty Stainless-Steel Body & Subframe
- Stainless Steel Plumbing and Manifold
- Black Out Trim Package
- Front Bumper Compartment for Rescue Tool Storage
- ROM Painted Roll-up Doors
- Darley PSM 1500-GPM Split Shaft Pump
- Trident Air Primer, Two (2) Locations
- Top Control Pump Module
- 1000-Gallon Poly Tank
- Five (5) 2 1/2" Discharges, Two (2) Left, Two (2) Right, One (1) Rear
- One (1) 3" Discharge, Right Side
- One (1) 2 1/2" Gated Suction, Left Side
- 5" Rear Suction
- 3" Deck Gun Piping
- Akron Apollo Deck Gun w/ Elkhart Monitor Riser
- One (1) 2 1/2" Front of Hosebed Preconnect
- Two (2) 1 1/2" Mattydale Preconnects
- Two (2) Triple Air Bottle Wheel Well Compartments, One (1) Each Side
- Zico Hydraulic Ladder Rack, Right Side
- Suction Hose Storage, Left Side Compartment Top and Right Rear Compartment
- Whelen LED Warning Light Package
- FireTech LED Scene Light Package
- Audiovox Color Observation Back-up Camera System
- 10' Overall Height
- 36' 6" Overall Length
- 238" Wheelbase
- 170.5" Cab to Axle
- 21,500 FAWR
- 31,500 RAWR
- 53,000 GVWR



To view more photos and download spec sheet, please visit us at AlexisFire.com.

IN THE EVENT THERE ARE DISCREPANCIES BETWEEN THE DRAWING AND THE SPECIFICATIONS, THE SPECIFICATIONS SHALL PREVAIL.

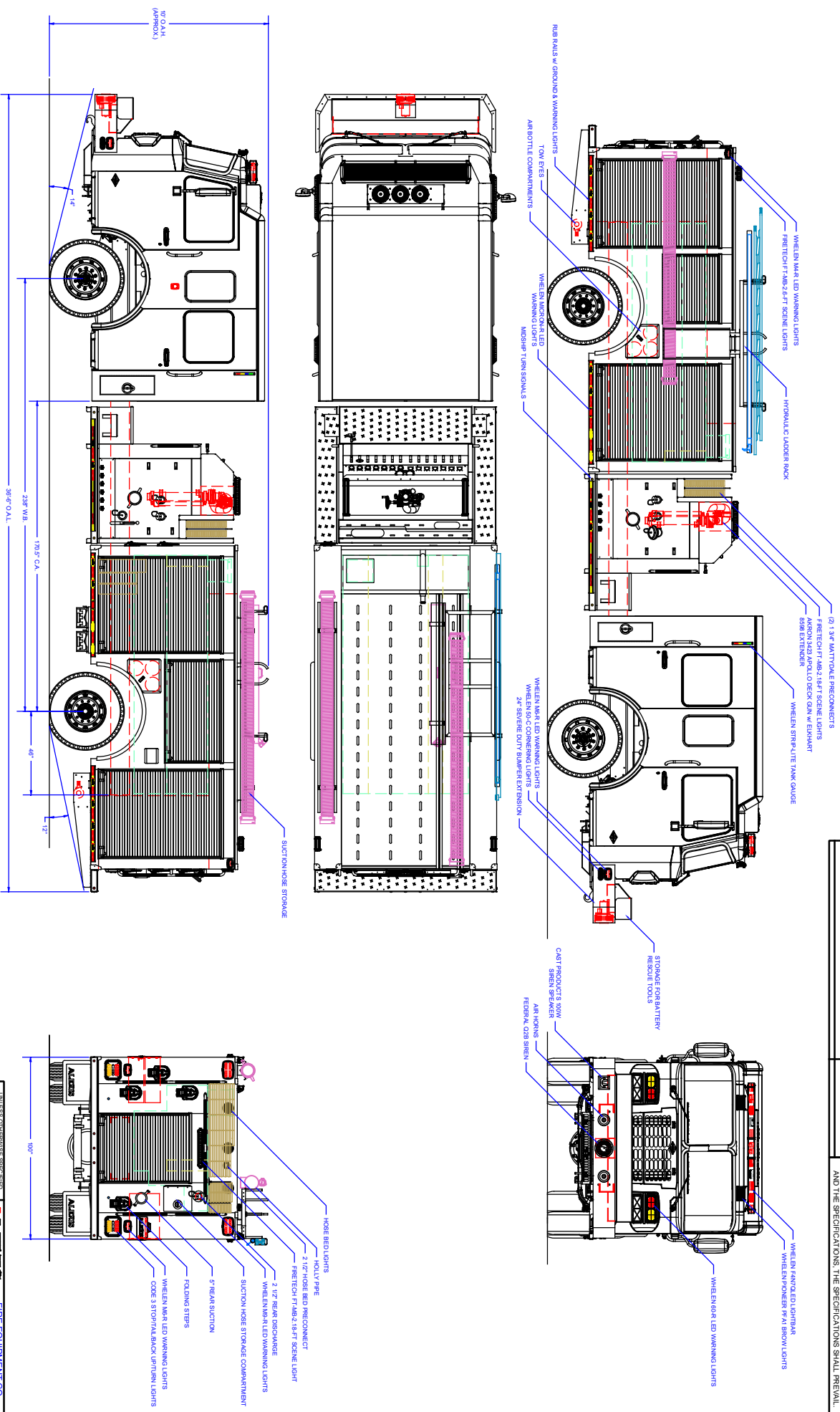

COMPARTMENT DIMENSIONS									
DOOR OPENING SIZES									
COMP #	57" WIDE X 87" HIGH X 12' DEEP				57" WIDE X 87" HIGH X 12' DEEP				
L1	L1 & R1				L1 & R1				
L2	54" WIDE X 80" HIGH X 12' DEEP				54" WIDE X 80" HIGH X 12' DEEP				
R2	35" WIDE X 28" HIGH X 12' DEEP				35" WIDE X 28" HIGH X 12' DEEP				
REAR	46" WIDE X 55" HIGH X 12' DEEP				46" WIDE X 55" HIGH X 12' DEEP				
MATERIAL					MATERIAL				
35" WIDE X 46" HIGH X 28" DEEP					35" WIDE X 46" HIGH X 28" DEEP				
PUMPER									
AKRON PRINCEVILLE FIRE DEPT.									
PRINCEVILLE, IL.									
Pump info:									
Control Location: Top									
Pump Drive: Split Shaft									
Chassis: Station 67' BOC									
Tank Capacity: 1000									
Pump Model: P5M									
Pump GPM: 1500									
Material: Stainless Steel									
REVISION HISTORY									
REV	DESCRIPTION	DATE	BY	SALES UPGRADES	DATE	BY	SALES UPGRADES	DATE	BY
01	CHANGED ORDER A	02/20/23	7	SALES UPGRADES	02/20/23	7	SALES UPGRADES	02/20/23	7