

SIDE CONTROL 4X4 PUMPER

REYNOLDS FIRE PROTECTION DISTRICT / REYNOLDS, ILLINOIS



ALEXIS



THANK YOU TO THE REYNOLDS FIRE PROTECTION DISTRICT FOR THE PURCHASE OF THIS UNIT.



TECHNICAL SPECIFICATIONS

- Kenworth T880 2 Door Chassis with 4x4 Conversion
- Cummins X15, 505-HP Diesel Engine
- Eaton FO-18E318B, 18 Speed Ultrashift Automatic Transmission
- Heavy Duty Stainless Steel Body and Sub-Frame
- ROM Roll Up Doors with one (1) right side hemmed pan door over rear wheel
- 1250-Gallon Poly Tank with 20-Gallon Foam Tank
- One (1) 4" Fire Programs Tank fills, rear
- One (1) Newton 10" square manual swivel dump with 36" extension
- Waterous CXSD 1500 GPM and CLVK 500-GPM PTO Pump, left side controls
- Four (4) 2 1/2" Discharges, two (2) left side, one (1) right side, one (1) rear
- Two (2) 3" Discharges, one (1) right side and one (1) over pump for Deck Gun
- Elkhart Vulcan RF monitor and Akron front bumper Turret
- Two (2) 2 1/2" Gated Suction, one (1) on each side
- Two (2) 1 1/2" Mattydale Preconnects, across top of body
- Two (2) Electric Booster Reels with 150' of 1" hose, one (1) each side
- Waterous Aquis 6 Foam System
- Custom AFE Stainless Steel Brush Guard
- Four (4) Dual bottle Air bottle compartments, two (2) each side wheel well
- Two (2) Suction hose/Pike pole storage compartments with rear access
- Electric Ladder Rack, right side compartment top
- Two (2) bottle 6000-PSI Cascade system with control panel
- One (1) Hinged Tool board, left side
- Zico Quick Index SCBA bracket for four (4) complete SCBA packs
- Floor mounted console for emergency switches with map/binder storage, cab
- Progressive Dynamics on-board battery charger with Kussmaul Super Auto Eject
- Whelen Electronic Siren with 100-watt speaker
- Two (2) Hadley Air Horns, one (1) each side of the hood
- Firetech and Akron LED Scene Light Packages
- Whelen LED Warning Light Package
- Diamond Grade chevron pattern striping, rear
- 11' 5" Overall height
- 30' Overall length
- 220" Wheelbase
- 152" Cab to Axle
- 18,180 FAWR
- 30,000 RAWR
- 48,180 GVWR



To view more photos and download spec sheet, please visit us at AlexisFire.com.

CUSTOMER APPROVAL SIGNATURE: _____ DATE: _____

REYNOLDS-0003

IN THE EVENT THERE ARE DISCREPANCIES BETWEEN THE DRAWING AND THE SPECIFICATIONS, THE SPECIFICATIONS SHALL PREVAIL.

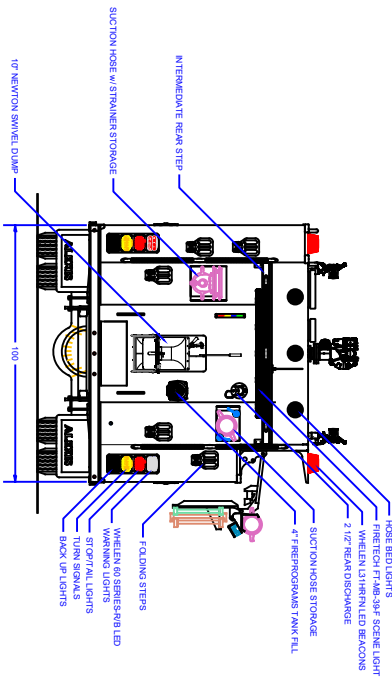
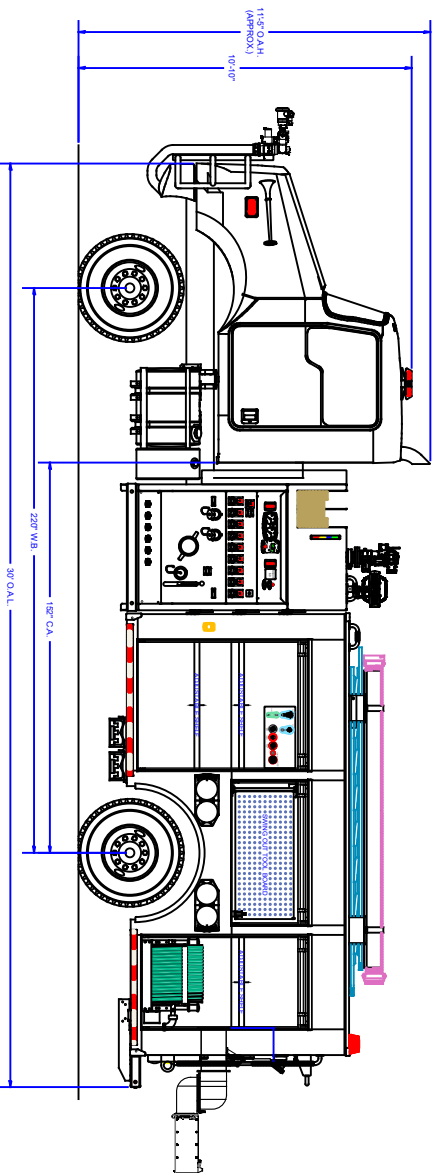
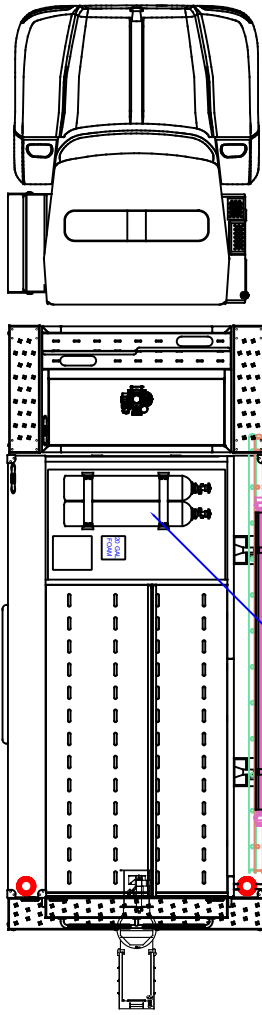
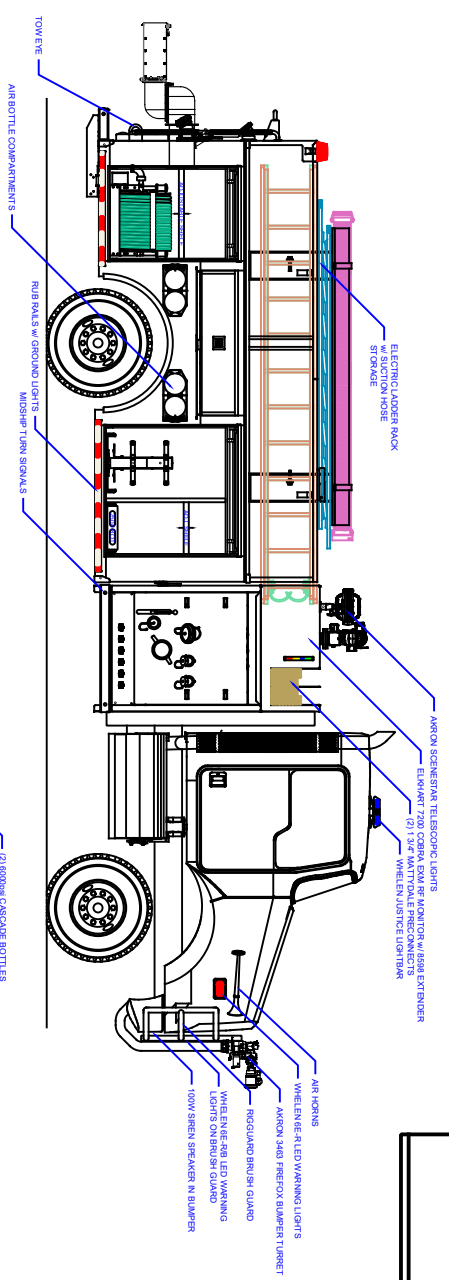

COMPARTMENT DIMENSIONS

COMP #	DOOR OPENING SIZES
L1	49" WIDE X 87" HIGH X 122" DEEP
L2	54" WIDE X 28" HIGH X 112" DEEP
L3	34" WIDE X 80" HIGH X 122" DEEP
R1	49" WIDE X 44" HIGH X 28" DEEP
R2	54" WIDE X 13" HIGH X 12" DEEP
R3	34" WIDE X 48" HIGH X 28" DEEP

UNLESS OTHERWISE SPECIFIED, DIMENSIONS ARE IN INCHES. (CONVERSIONS ARE NOT GUARANTEED)

PUMP INFO:
 Control Location: Side
 Apparatus Type: Pumper
 Pump Drive: Shaft Shaft
 Chassis: Kenworth 230R
 Tank Capacity: 1250
 Pump Model: CX Series
 Material: Stainless Steel

ALEXIS FIRE EQUIPMENT CO.
 P.O. BOX 518 ALEXIS ILLINOIS 61412
SIDE CONTROL PUMPER
REYNOLDS FIRE PRO DIST
 REYNOLDS, IL
 M/TINKHAM 11/17/17
 SIZE SCALE: 1/2" = 1'
 CONTRACT # 2356 SHEET 1 OF 2

REV	DESCRIPTION	DATE	BY
01	ISSUES IMPROVES	11/17/17	M/T
02	ISSUES IMPROVES	11/17/17	M/T
03	ISSUES IMPROVES	11/17/17	M/T

8 7 6 5 4 3 2 1