

# TOP CONTROL PUMPER



## NORTHWEST FIRE PROTECTION DISTRICT ROCKFORD, ILLINOIS

### TECHNICAL SPECS

- Spartan Metro Star EMFD 10" raised roof Chassis
- Cummins ISL, 425-HP Diesel Engine
- Allison 3000 EVS Automatic Transmission
- Six (6) man seating with five (5) SCBA seats
- Heavy Duty 3/16" Aluminum Body
- ROM Roll Up Doors
- 24" Front bumper extension with 5" Suction, preconnect and center hosewell
- 1000-Gallon Poly Tank with 30-Gallon foam tank
- Waterous CXS. 1250-GPM Pump
- Pump operator's panel across top of body
- Four (4) 2 1/2" Discharges, one (1) each side and two (2) rear
- Two (2) 4" Discharges, one (1) each side
- One (1) 3" Discharge, over pump for deck gun
- Two (2) 1 1/2" Cartridge Lay Preconnects, front of body
- Waterous Aquis 2.5 Foam System
- One (1) 2 1/2" Gated Suction, left side
- Three (3) Triple bottle Air bottle compartments, two (2) right and one (1) left side
- Suction hose storage compartment with rear access, right side
- Ziamatic Electrically controlled Ladder rack, left side
- Kussmaul 1200 pump plus on-board battery charger with air compressor
- Two (2) Air Horns, front bumper
- Whelen Electronic Siren with 100-watt Whelen speaker
- Federal Q2B Siren, front bumper
- Whelen LED 12-volt brow light
- Smart Power 8000-watt hydraulically driven Generator with 120-volt system
- One (1) Akron Electric cord reel with 150-ft of 10/3 cord and junction box
- Two (2) FRC Focus 120-volt 750-watt telescopic lights, one (1) each side
- Whelen LED Warning Light Package
- Chevron pattern striping, rear
- 9' 8" Overall height
- 32' 6" Overall length
- 200" Wheelbase
- 146" Cab to Axle
- 20,000 FAWR
- 27,000 RAWR
- 47,000 GVWR



To view more photos,  
visit [www.AlexisFire.com](http://www.AlexisFire.com)

WE WOULD LIKE TO THANK  
THE NORTHWEST FIRE PROTECTION  
DISTRICT FOR THEIR BUSINESS.



Demand To Be Different.

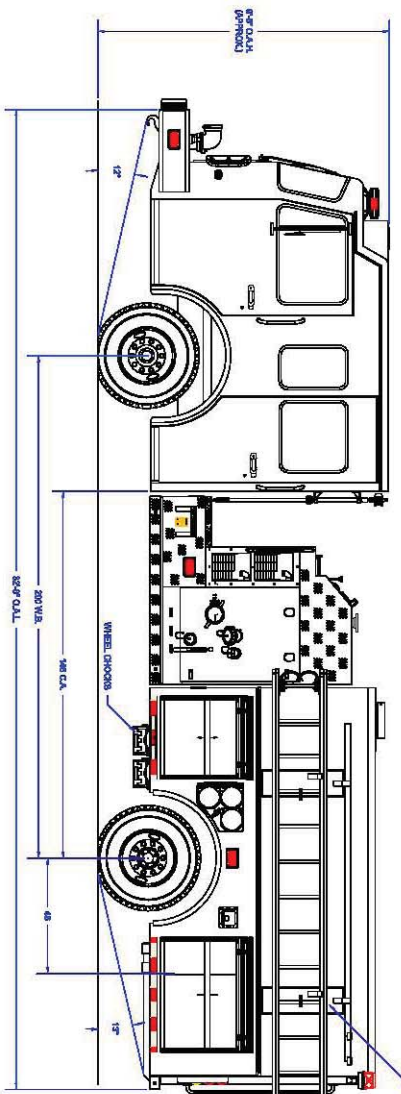
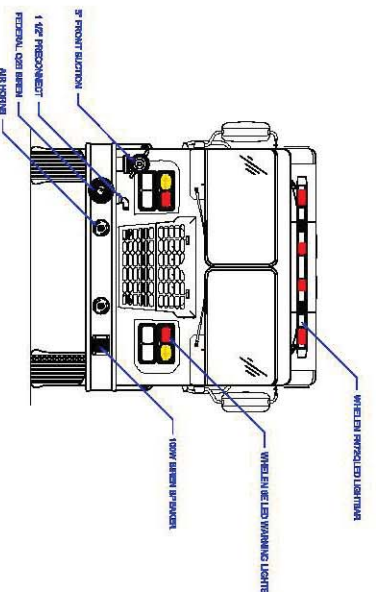
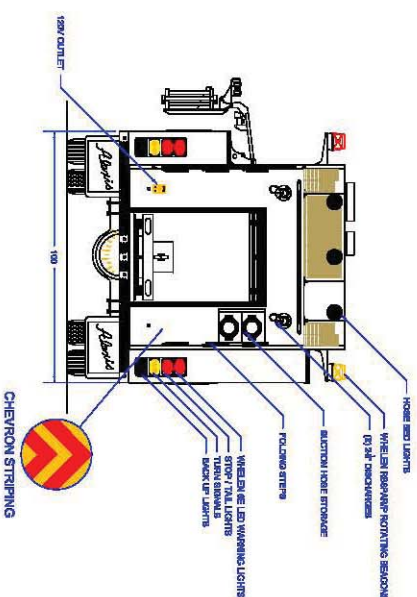

COMP #	DOOR OPENING SIZES
L1	36" WIDE X 68" HIGH X 28" DEEP
L3	42" WIDE X 68" HIGH X 28" DEEP
R1	36" WIDE X 68" HIGH X 12" DEEP
R2	36" WIDE X 68" HIGH X 12" DEEP
R3	42" WIDE X 68" HIGH X 12" DEEP
REAR	36" WIDE X 68" HIGH X 28" DEEP

**FIRE DEPARTMENT**  
 10000 10TH AVE N  
 ALBUQUERQUE, NM 87113  
 (505) 261-1000

P.O. BOX 404, ALBUQUERQUE, NM 87104  
 (505) 261-1000

**TOP MOUNT PUMPER**  
**NORTHWEST FIRE PROTECTION DIST**

CUSTOMER APPROVAL SIGNATURE:		DATE:	
NORTHWEST-0002			
IN THE EVENT THERE ARE DISCREPANCIES BETWEEN THE DRAWING AND THE SPECIFICATIONS, THE SPECIFICATIONS SHALL PREVAIL.			
REV	DESCRIPTION	DATE	BY
01	QUANTITY	08/03/2006	08/03/2006
02	QUANTITY	08/03/2006	08/03/2006
03	QUANTITY	08/03/2006	08/03/2006
04	QUANTITY	08/03/2006	08/03/2006
05	QUANTITY	08/03/2006	08/03/2006
06	QUANTITY	08/03/2006	08/03/2006
07	QUANTITY	08/03/2006	08/03/2006
08	QUANTITY	08/03/2006	08/03/2006
09	QUANTITY	08/03/2006	08/03/2006
10	QUANTITY	08/03/2006	08/03/2006
11	QUANTITY	08/03/2006	08/03/2006
12	QUANTITY	08/03/2006	08/03/2006
13	QUANTITY	08/03/2006	08/03/2006
14	QUANTITY	08/03/2006	08/03/2006
15	QUANTITY	08/03/2006	08/03/2006
16	QUANTITY	08/03/2006	08/03/2006
17	QUANTITY	08/03/2006	08/03/2006
18	QUANTITY	08/03/2006	08/03/2006
19	QUANTITY	08/03/2006	08/03/2006
20	QUANTITY	08/03/2006	08/03/2006
21	QUANTITY	08/03/2006	08/03/2006
22	QUANTITY	08/03/2006	08/03/2006
23	QUANTITY	08/03/2006	08/03/2006
24	QUANTITY	08/03/2006	08/03/2006
25	QUANTITY	08/03/2006	08/03/2006
26	QUANTITY	08/03/2006	08/03/2006
27	QUANTITY	08/03/2006	08/03/2006
28	QUANTITY	08/03/2006	08/03/2006
29	QUANTITY	08/03/2006	08/03/2006
30	QUANTITY	08/03/2006	08/03/2006
31	QUANTITY	08/03/2006	08/03/2006
32	QUANTITY	08/03/2006	08/03/2006
33	QUANTITY	08/03/2006	08/03/2006
34	QUANTITY	08/03/2006	08/03/2006
35	QUANTITY	08/03/2006	08/03/2006
36	QUANTITY	08/03/2006	08/03/2006
37	QUANTITY	08/03/2006	08/03/2006
38	QUANTITY	08/03/2006	08/03/2006
39	QUANTITY	08/03/2006	08/03/2006
40	QUANTITY	08/03/2006	08/03/2006
41	QUANTITY	08/03/2006	08/03/2006
42	QUANTITY	08/03/2006	08/03/2006
43	QUANTITY	08/03/2006	08/03/2006
44	QUANTITY	08/03/2006	08/03/2006
45	QUANTITY	08/03/2006	08/03/2006
46	QUANTITY	08/03/2006	08/03/2006
47	QUANTITY	08/03/2006	08/03/2006
48	QUANTITY	08/03/2006	08/03/2006
49	QUANTITY	08/03/2006	08/03/2006
50	QUANTITY	08/03/2006	08/03/2006
51	QUANTITY	08/03/2006	08/03/2006
52	QUANTITY	08/03/2006	08/03/2006
53	QUANTITY	08/03/2006	08/03/2006
54	QUANTITY	08/03/2006	08/03/2006
55	QUANTITY	08/03/2006	08/03/2006
56	QUANTITY	08/03/2006	08/03/2006
57	QUANTITY	08/03/2006	08/03/2006
58	QUANTITY	08/03/2006	08/03/2006
59	QUANTITY	08/03/2006	08/03/2006
60	QUANTITY	08/03/2006	08/03/2006
61	QUANTITY	08/03/2006	08/03/2006
62	QUANTITY	08/03/2006	08/03/2006
63	QUANTITY	08/03/2006	08/03/2006
64	QUANTITY	08/03/2006	08/03/2006
65	QUANTITY	08/03/2006	08/03/2006
66	QUANTITY	08/03/2006	08/03/2006
67	QUANTITY	08/03/2006	08/03/2006
68	QUANTITY	08/03/2006	08/03/2006
69	QUANTITY	08/03/2006	08/03/2006
70	QUANTITY	08/03/2006	08/03/2006
71	QUANTITY	08/03/2006	08/03/2006
72	QUANTITY	08/03/2006	08/03/2006
73	QUANTITY	08/03/2006	08/03/2006
74	QUANTITY	08/03/2006	08/03/2006
75	QUANTITY	08/03/2006	08/03/2006
76	QUANTITY	08/03/2006	08/03/2006
77	QUANTITY	08/03/2006	08/03/2006
78	QUANTITY	08/03/2006	08/03/2006
79	QUANTITY	08/03/2006	08/03/2006
80	QUANTITY	08/03/2006	08/03/2006
81	QUANTITY	08/03/2006	08/03/2006
82	QUANTITY	08/03/2006	08/03/2006
83	QUANTITY	08/03/2006	08/03/